

NEW HEBEL POWERFENCE.

Solid, beautiful
and easy to install.



HEBEL POWERFENCE – HIGH PERFORMANCE AFFORDABLE RENDERED MASONRY FENCING SOLUTION

Your choice of fencing is important to the overall look, security and value of your home. A beautiful home will be enhanced by an attractive and solid feeling masonry fence.

Now you can afford a premium quality masonry fence with Hebel PowerFence. It's a simple to build modular fencing system that provides all the privacy and noise reduction benefits of traditional brick fencing with a fraction of the construction time, mess and cost.

Perfect for boundary fencing, low front walls and sloping sites, Hebel PowerFence uses lightweight autoclaved aerated concrete panels with custom steel posts and brackets which can be easily and quickly erected without the need for extensive excavation or strip footings.

DESIGNED FOR TODAY'S STYLISH HOMES

Hebel PowerFence enhances the look of today's render finished homes, blending seamlessly to create clean flowing lines. Its excellent weather resistance will provide a look you'll love that outlasts timber fencing.

DESIGN FLEXIBILITY

Hebel PowerFence panels can be finished with a choice of expressed joints or a monolithic look. The fence can also be adapted to include a range of different decorative treatments such as timber panels or ironwork to compliment the style of your home.



DECORATE WITH A
RANGE OF PROFILES
AND LOOKS

POWERFENCE:

- simple, cost effective and attractive
- creates privacy and reflects noise
- unlimited design flexibility
- non combustible, durable and termite resistant
- suitable for bushfire prone areas
- engineered for the majority of conditions in Australia.

SOLID AND SECURE

The PowerFence system uses 75mm Hebel PowerPanel with specially coated steel reinforcement to deter corrosion and provide maximum durability. PowerFence is non-combustible and termite resistant, the perfect choice for bushfire prone areas.

MAKES FENCING FAST AND EASY

The new PowerFence system has been redesigned from the ground up with a focus on simplicity and versatility to make construction faster and easier for builders and homeowners. A major innovation of the new system is the combination of universal posts and adjustable brackets which support the 75mm thick PowerPanels and allow for a variety of configurations with the minimum number of components. Combined with lighter panels, the brackets make the new PowerFence system much faster to install than traditional masonry fencing.

The posts are simply embedded in concrete footings and brackets are screwed to the posts at the desired heights to support the panels.

The 600mm wide panels are installed horizontally and are available in lengths of 1800mm and 2400mm. Panels can be stacked up to 3 high and glued to create a solid barrier up to 1800mm high. Post covers and a choice of cappings complete the fence ready for your choice of coating or render.

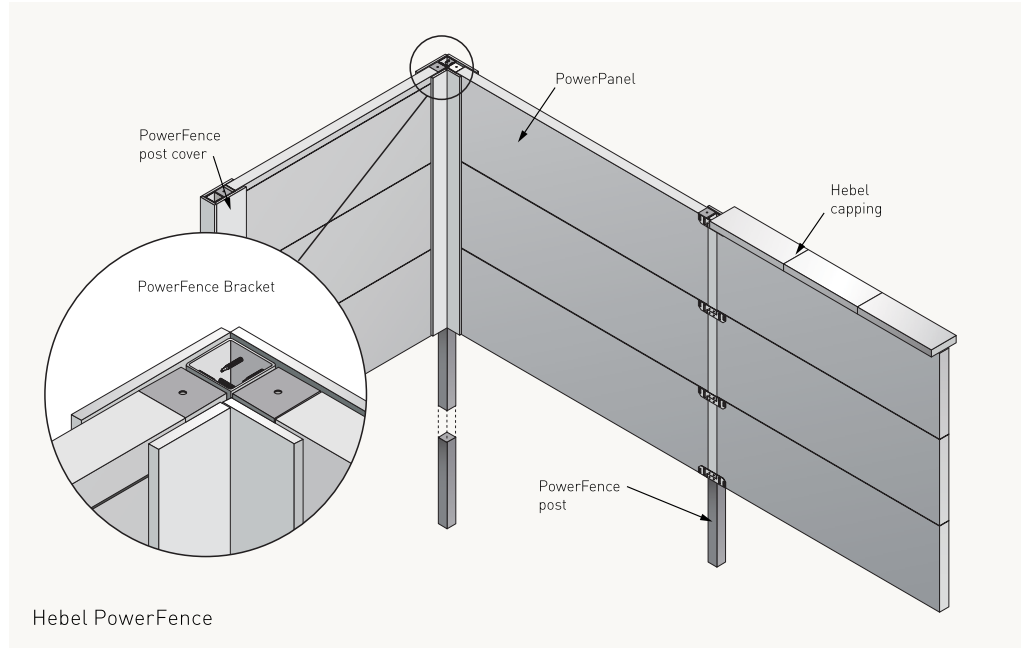

THE VERSATILE HEBEL POWERFENCE BRACKET*

Multi-purpose and adjustable for all-round easier and safer construction. Move it up or down while constructing. Rotate it to make a corner. Turn it upside down for a starting cleat. Use it as a lateral support for all the panels. Separate its two integrated sections for stepped or terraced fencing. Reposition and refix if need be, as you go.

* Hebel PowerFence Bracket patent pending.

NORMAL STRAIGHT POSITION

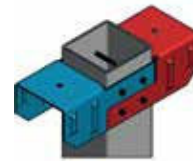

NORMAL CORNER POSITION

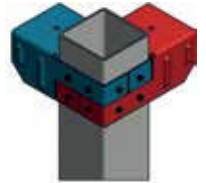

CLEAT STRAIGHT POSITION

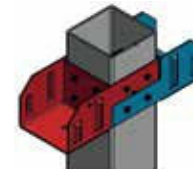

CLEAT CORNER POSITION

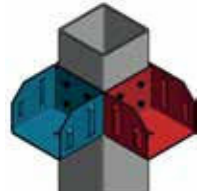

EASY TO USE FOR A VARIETY OF FENCE CONFIGURATIONS

The versatility of the PowerFence system makes it ideal for boundary and decorative fences up to 1800mm high. The innovative brackets also make it easy to install on sites with up to 15 degree slope.



SIMPLE, COST
EFFECTIVE AND
ATTRACTIVE





PEACE OF MIND

With a proven track record for over 70 years worldwide, you can depend on Hebel. In Australia Hebel products and systems are designed and developed by CSR, one of Australia's oldest and most trusted companies and are warranted to maintain their structural integrity and stability for the life of your home.

An innovative, sustainable and proven building product, Hebel PowerFence has impressive benefits:



SOLID AND STRONG

Hebel 75mm steel reinforced PowerFence panels provide the solid feel, security and peace-of-mind associated with traditional bricks. In fact, independent tests show that a rendered Hebel wall has similar impact resistance to brick.



FIRE RESISTANT

Hebel is renowned for its fire resistant properties. A non-combustible material, Hebel panel systems meet or exceed the requirements for all six Bushfire Attack Level (BAL) categories. When building with Hebel, you're building with peace-of-mind that your home is safe and secure.



SUSTAINABILITY FOR A BETTER WORLD

Environmentally friendly, Hebel products and systems are the sustainable choice. Independent testing shows that overall Hebel has a 30% lower environmental impact than concrete or brick veneer. Using over 60% less embodied energy, and producing at least 55% less greenhouse emissions than concrete or brick veneer, Hebel is the cleaner, greener choice.



FAST TO CONSTRUCT & COST EFFECTIVE

Hebel PowerFence system is quickly and easily erected without the need for extensive excavation or strip footings as in the case for a traditional brick fence. There is less wastage and no mess.



BETTER ACOUSTICS

Hebel PowerFence is the perfect sound barrier, keeping the noise of the exterior world out and your home and outdoor living areas a little more peaceful and quiet.



PROVEN AND BACKED BY CSR

Hebel products and systems are designed, developed and warranted in Australia by CSR.



The better way to build

Visit www.hebel.com.au and view our How to build a Hebel PowerFence video, or call 1300 443 235.

Hebel® is a registered trademark of the Xella group. CSR Building Products Ltd is an exclusive licensee of Xella. CSR Hebel is a business of CSR Building Products Ltd ABN 55 008 631 356.